

C007

DIY handmade goods -- Cocoa's Fantastic Ideas



C007 Instruction Manual

NOTICE OF ASSEMBLE

Making tips

- LED wiring indication:
White=Positive; Grey=Negative.
- Use a craft blade to carefully skim over the plastic to bare the copper wire.
- For LED wiring extension, please refer to the below steps:

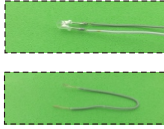

Twist the copper of both LED wire and extension wire together.

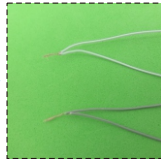

Do the same on the white wire.
Remarks: Tie a knot at the end of the grey wire to differentiate the polarity.

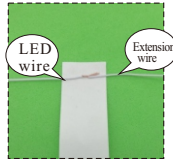

Place the duly twist wire on the tapes provided.



Roll and wrap the wire.

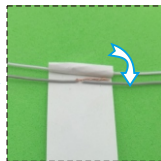

Place another wire next to it.
Remarks: DO NOT contact both copper wire to avoid short circuit.

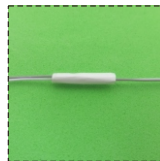

Roll and wrap it together.

Warnings

- The product is not suitable for children under 14 years old. The should be under custody of adults when playing with the product.
- There are small parts, please do not swallow them for avoiding dangerous accidents.

Tips for assembling

- Pictures shown on the package may be slightly different from the actual product.
- Please use the provided tracing paper for cutting purpose to achieve the best outcome.
- Product designs and specification may be subject to change without advance notice for purpose of making improvement.
- Testing on LED function:

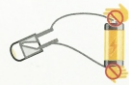

DO NOT contact the LED wire end direct to the battery cell.

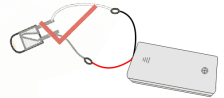

Use the provide battery holder. Make sue the correct polarity.

How to assemble the battery holder



1. Material and tools needed:
- Battery holder, LED bulb, tape.



2. Twist the following wire together:
(I) WHITE wire from the battery box with the GREY wire from LED bulb.
(II) GREY wire from the battery box with the WHITE wire from LED bulb.



3. Wrap the exposed wire with the tapes.



4. Tear off the rubber paper

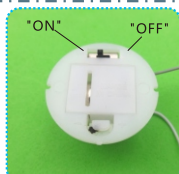

5. Set the black key on the battery box to one side of "ON" as shown.



6. Turn on the power and complete the installation.

Statement: the lamp wires cannot be inserted into the output socket.

- Please notice the place of anode and cathode when pit in the batteries
- Rechargeable batteries are not blunt electricity
- Rechargeable batteries can only be charged under adult supervision
- Rechargeable batteries should be removed from the toy before charging
- Different types of batteries cannot mix; Do not mix new batteries in use with semi-used batteries.
- Run out of battery should be removed from the toy
- The power shall not be short circuit

Product information



Cabinet

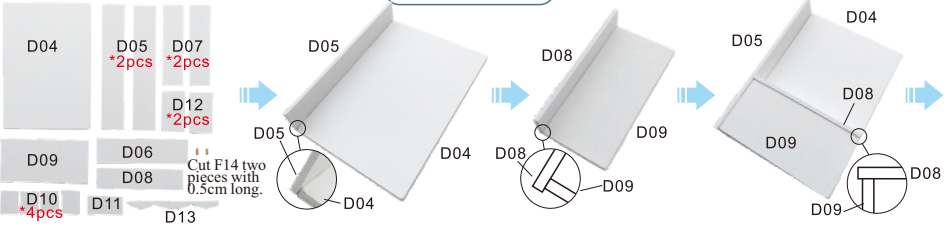

Use a pencil to draw the D07 in four, so as to make easy.

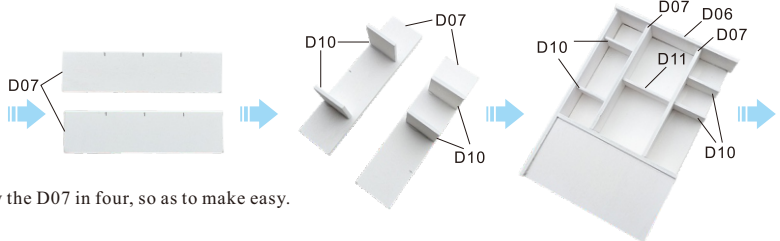

D13 (it is recommended that the A09-03 and A09-06 be put in the cabinet and then glued on D13 as shown.)

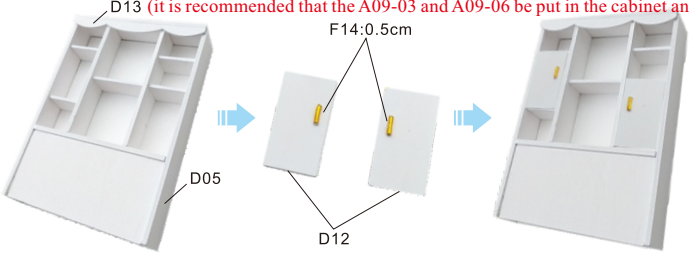

Chocolate A

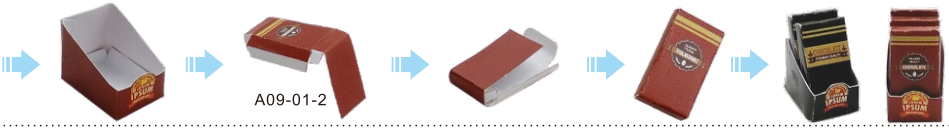
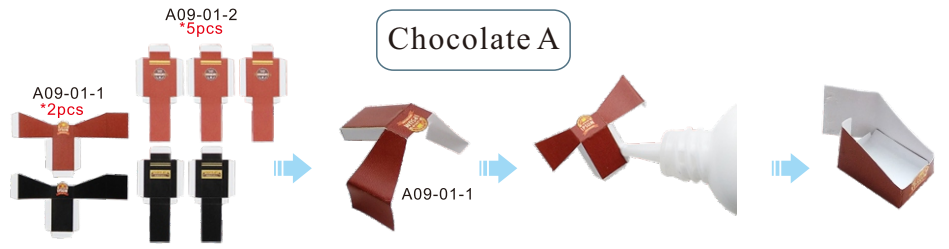

Chocolate B



Chocolate cup

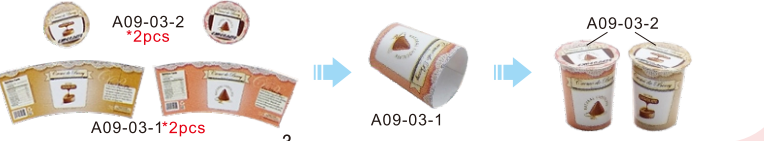

Chocolate sauce



Circular gift box



Gift box

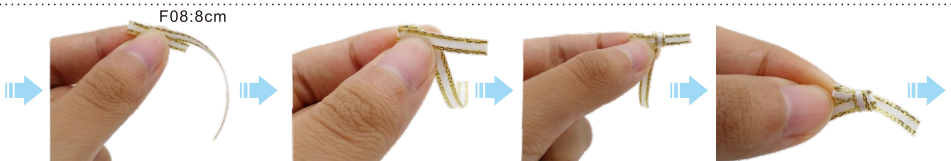
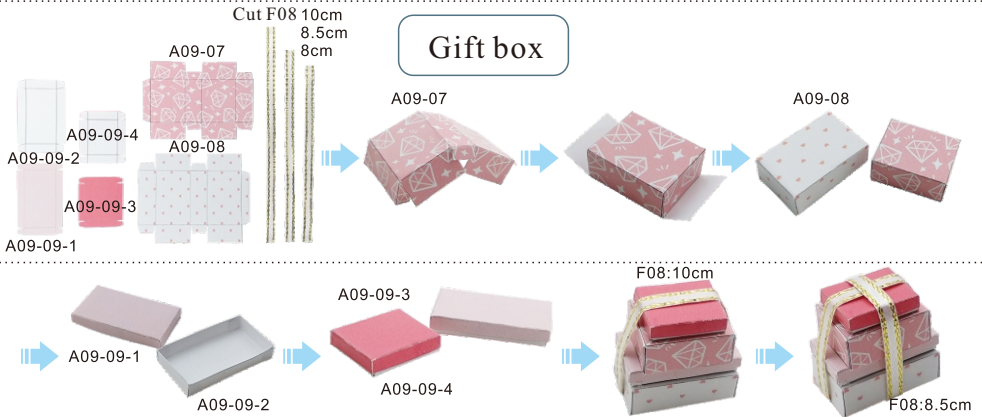

Display cabinet

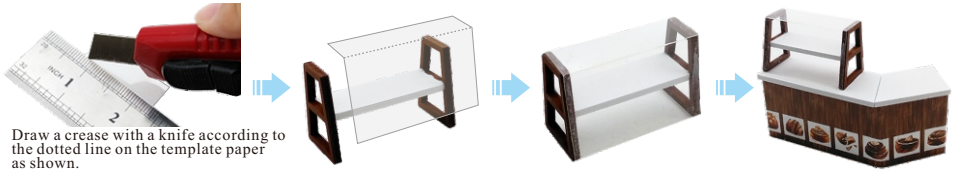
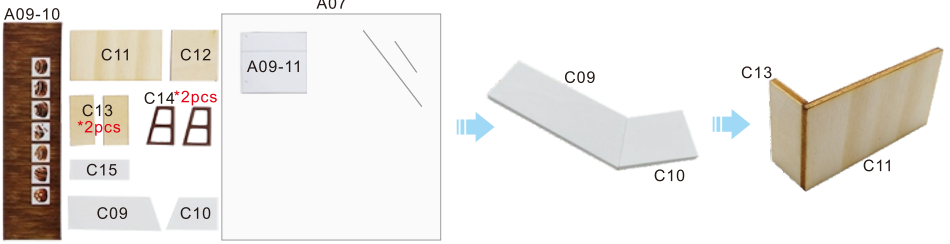

Chocolate cake

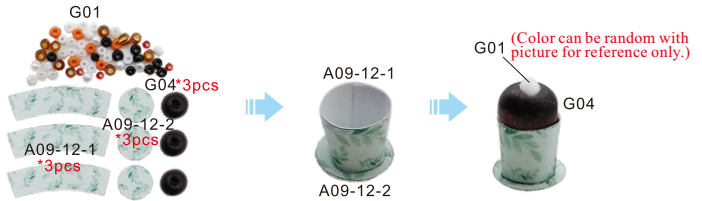

Chocolate C



Chocolate biscuit

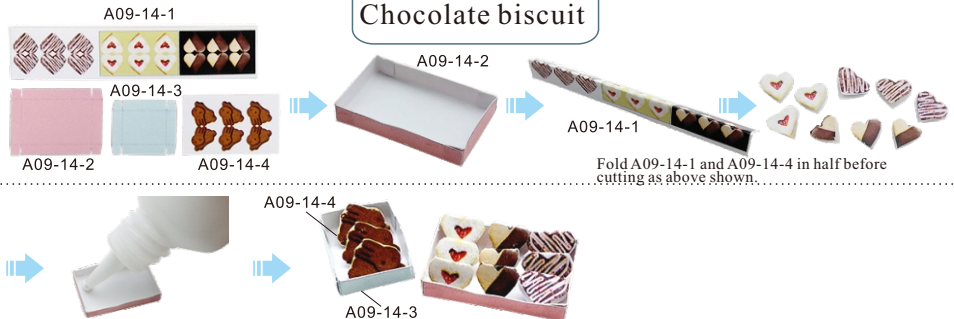

Chocolate platter

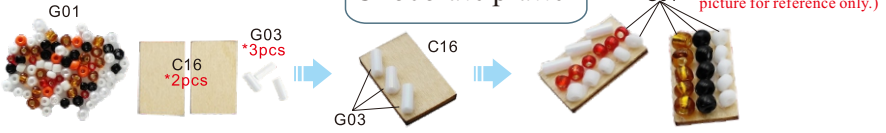

Chocolate lollipop



Chocolate box



Little flag



Cart

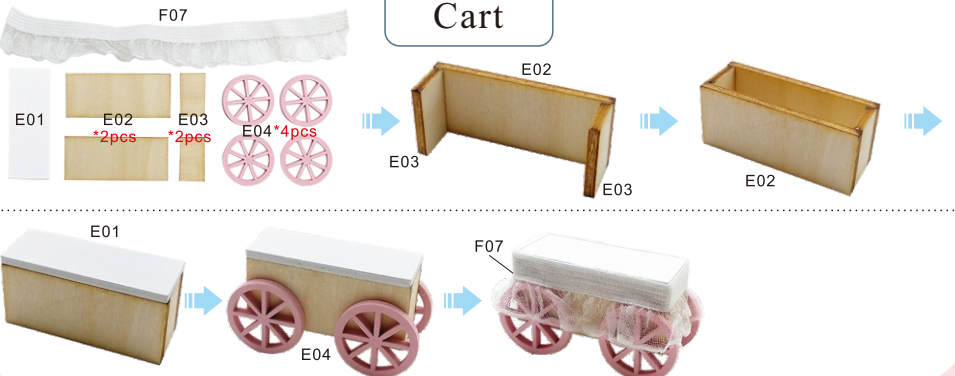

Heart chocolate

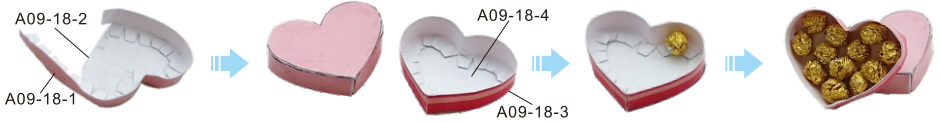
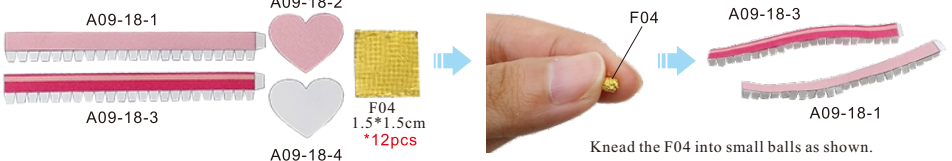

Chocolate tower

The making method of bow, please refer to page 4.

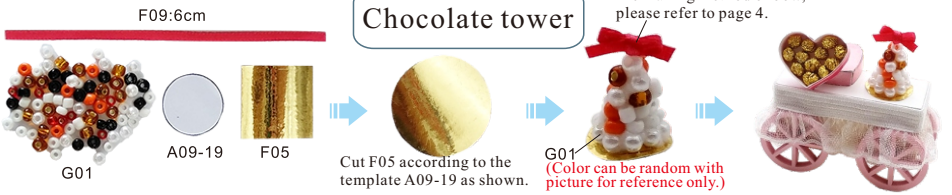

Counter



Chocolate D



Chocolate tray

The making method of A09-22, please refer to A09-07 (Page 4).



Sunshade

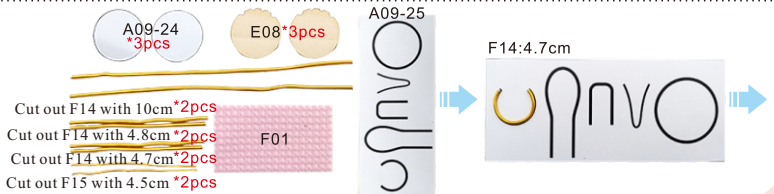

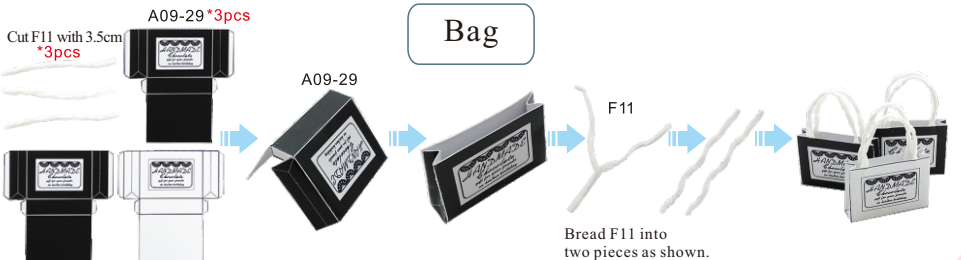
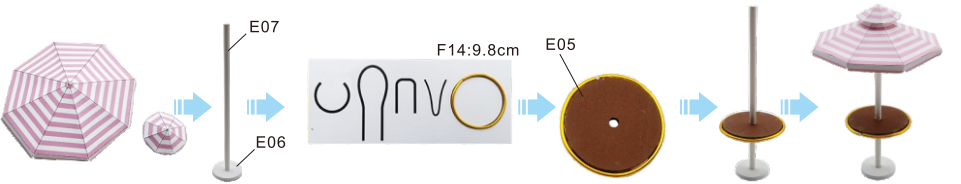
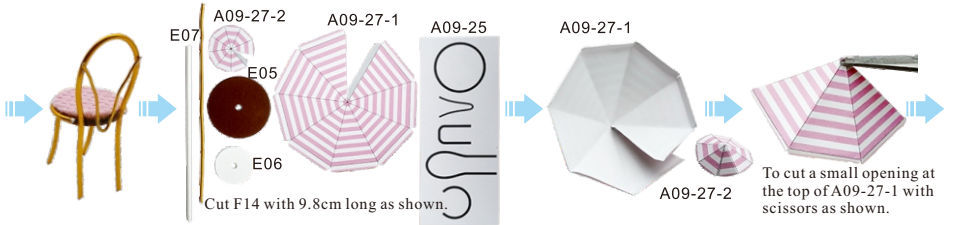
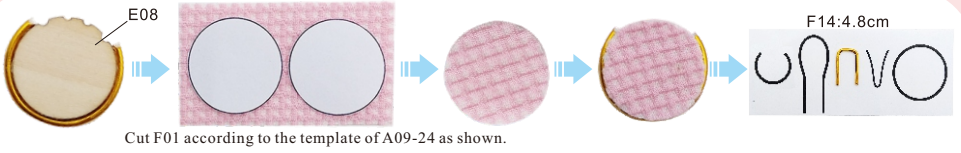

Tulips

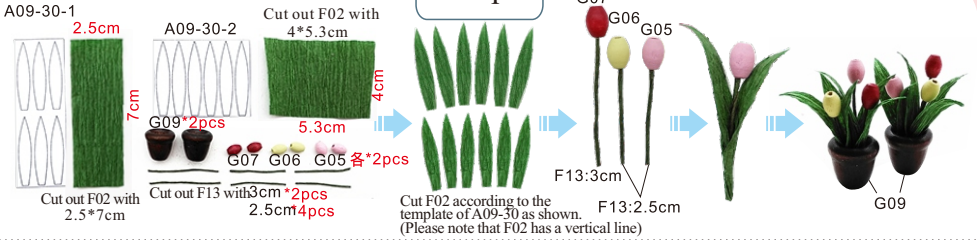

Flower

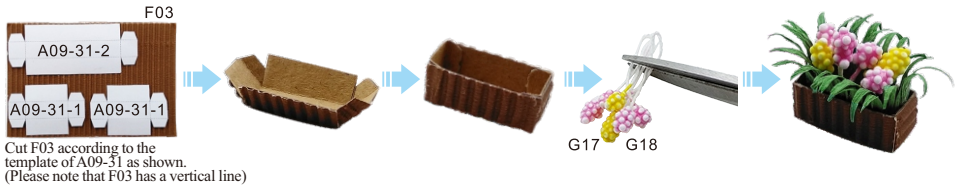
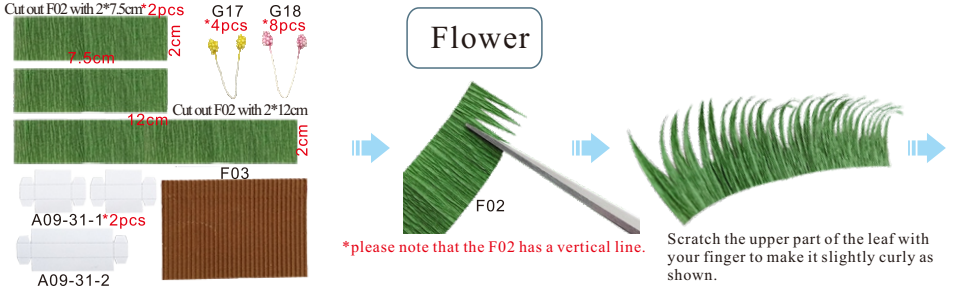

Sign



Floor sign



Window

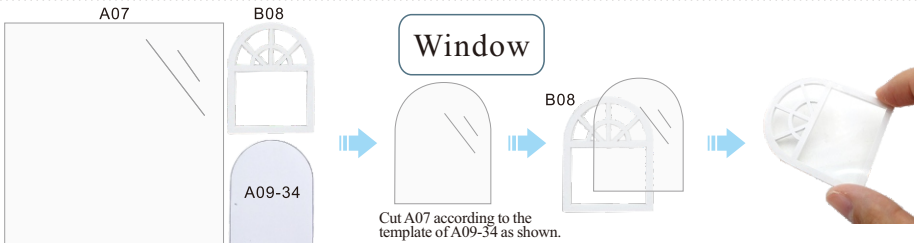

Wall deco



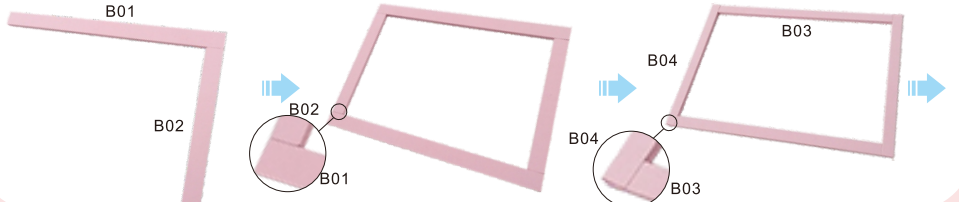
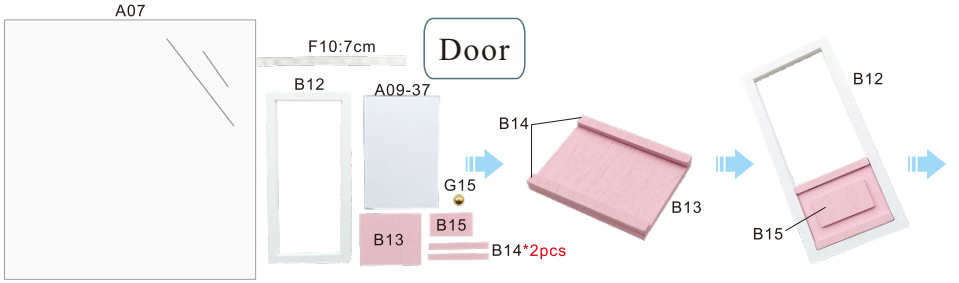
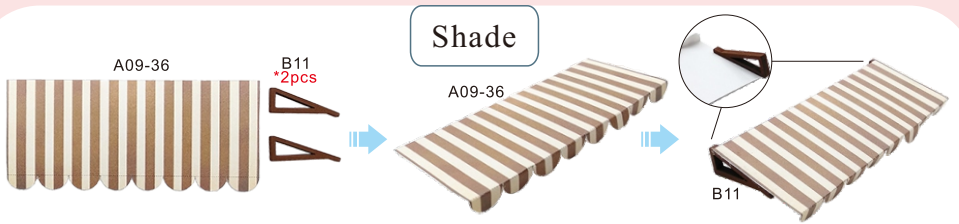

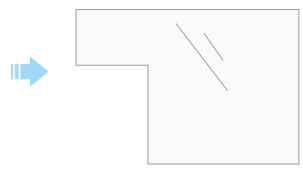
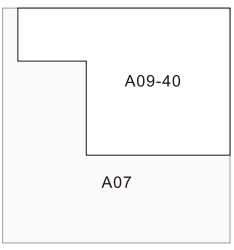
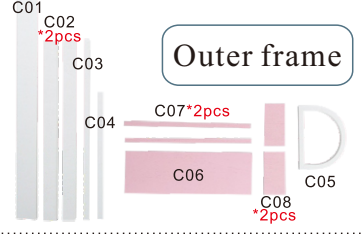
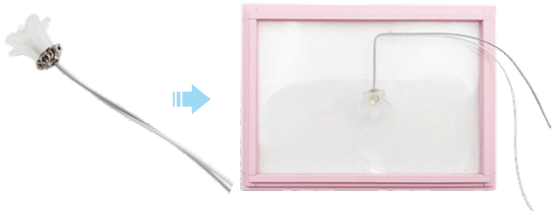
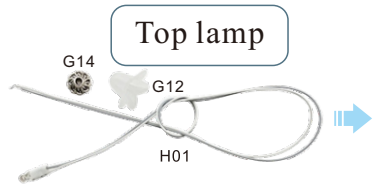
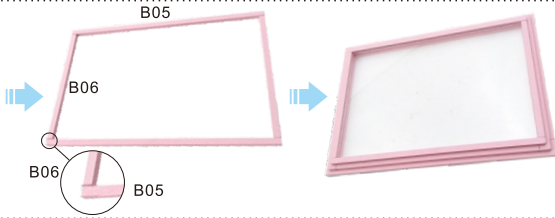
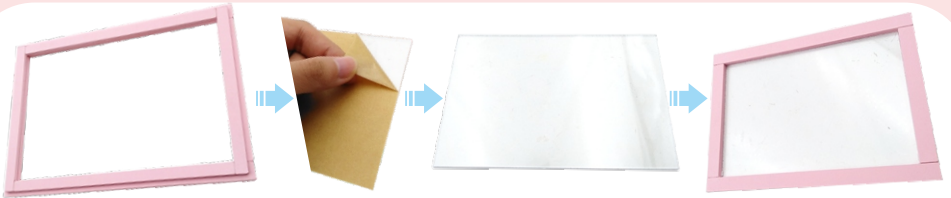

Cut A07 according to the template of A09-40 as shown.

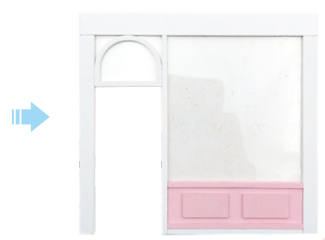
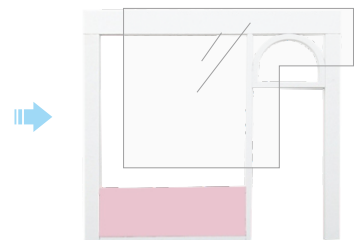
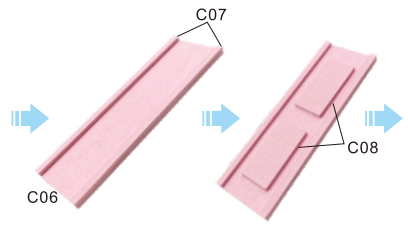
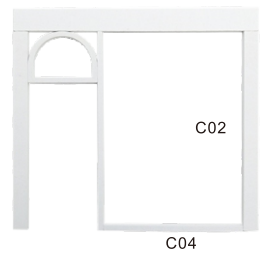
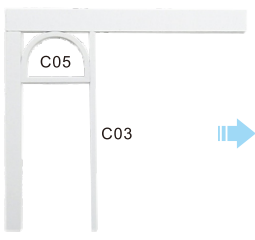
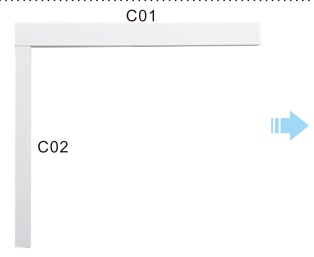

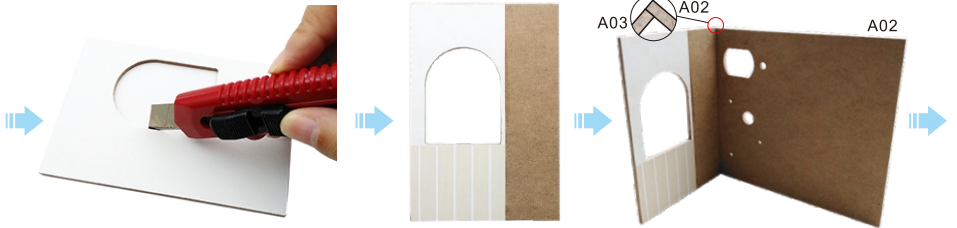
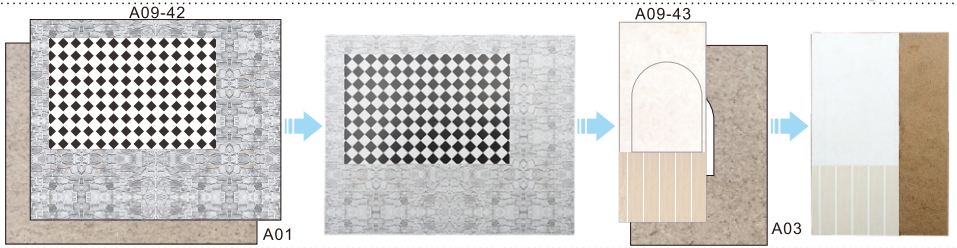
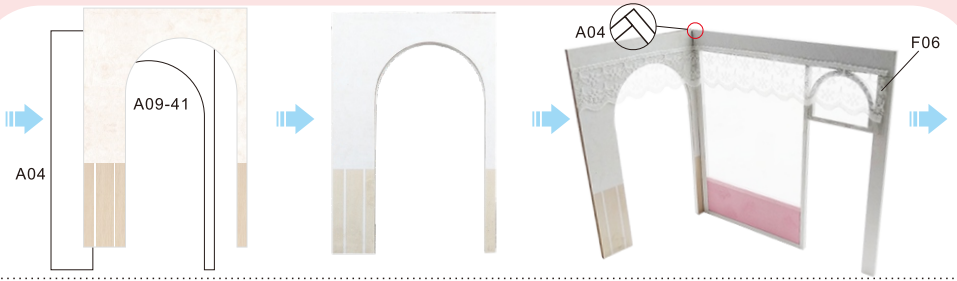

Music machine core manual guide
 (If you have purchased the music machine core, please fix it firstly)



(front view)

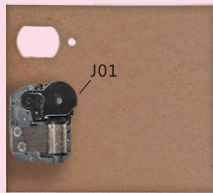

(back view)

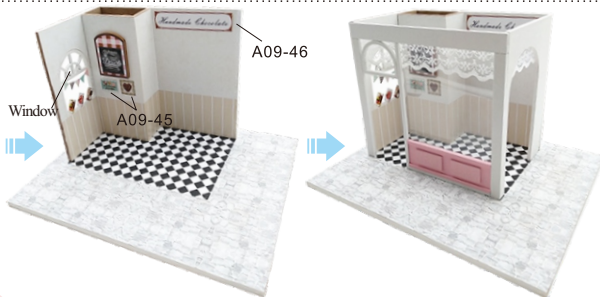
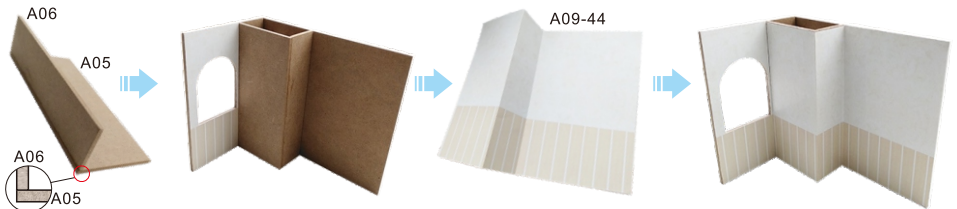
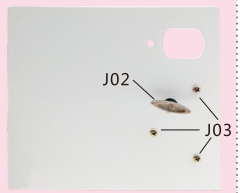

Shop sign

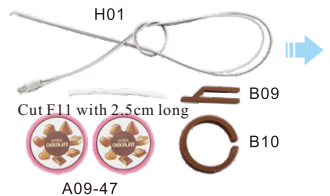



Break the F11 into two pieces.

A09-47

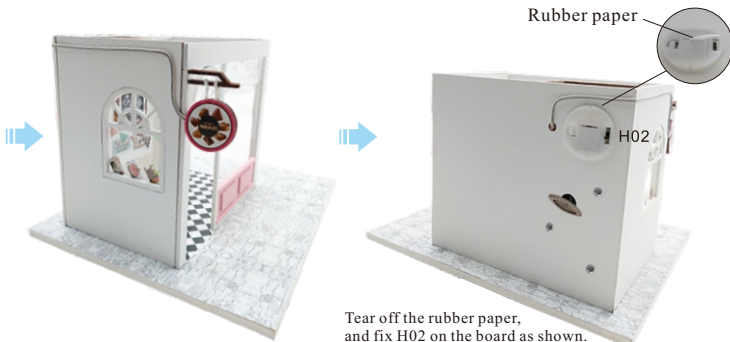

Rubber paper

Street light

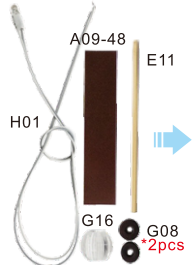

Tear off the rubber paper, and fix H02 on the board as shown.

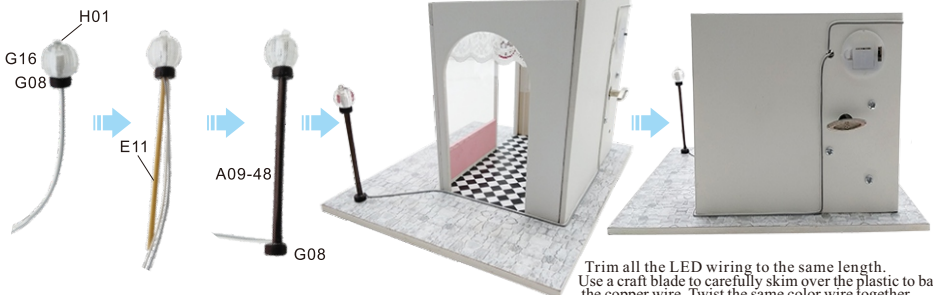

Trim all the LED wiring to the same length. Use a craft blade to carefully skim over the plastic to bare the copper wire. Twist the same color wire together.

Twist the following wire together:

- (I) WHITE wire from the battery box with the GREY wire from LED bulb.
- (II) GREY wire from the battery box with the WHITE wire from LED bulb.

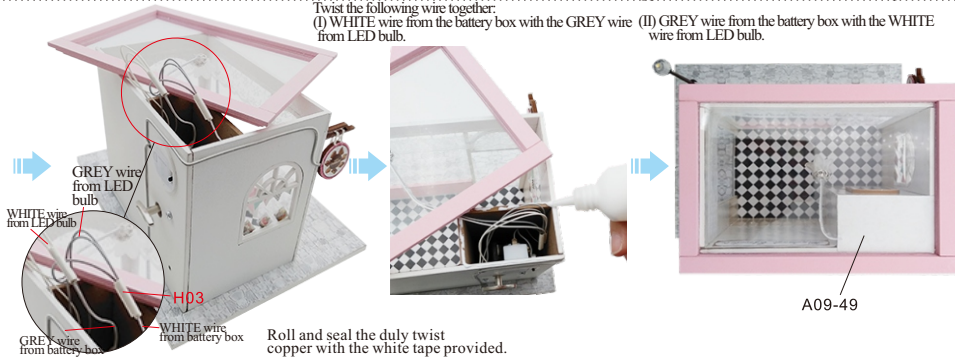

Roll and seal the duly twist copper with the white tape provided.

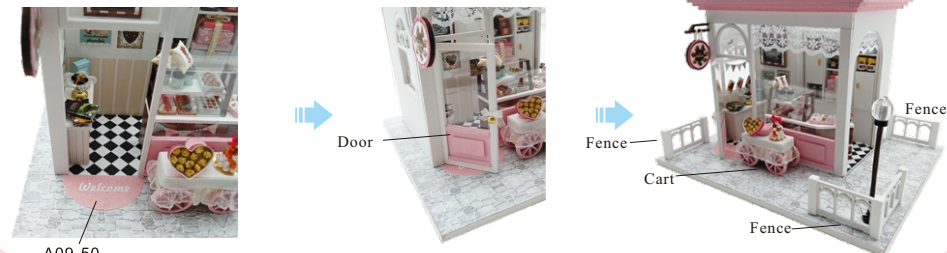

A09-50



Installation of dust proof cover
(For updated version, the parts need to be purchased separately)



J04 Transparent cover
 0.18*16*20 (3pieces)



J05 Transparent cover
 0.18*15.64*16(2pieces)



1. Tear off kraft paper of each piece of transparent cover.

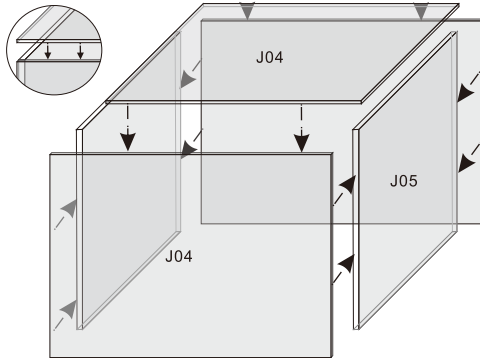

2. Paste J04 and J05 together to complete the dust proof cover as shown.

Photo of Dust proof cover



Photo Gallery





Attention: Please keep the instruction manual for future enquires after installation.